

# Downtown

Through this design, the main streets of Webberville are given a whole new look. The roads provide angled parking for nearby businesses, restaurants or shops. In the center of the roads, replacing the previously under used turn lane, will be attractive, bioswales. The vegetation will provide natural cleansing for water as it slowly drains through the soil. This in turn will alleviate some of the drainage issues of the town. Existing sidewalk planters will continue the use of softscape elements within the downtown. In addition to planters, reused outdoor furniture and lighting will add a sense of place for the downtown.



## Webberville Trail

Throughout the village, a new trail system has been designed for bike users, walkers or runners. It connects the industrial area with the downtown, creating a unity between the two locations.

## Recreation Hall

A community recreation hall for the village has been designed by renovating the existing church on the corner of Cherry and Howard Street. Activities such as bingo, scrabble, town meetings and gatherings could be held at this location. The rec hall will give community members a central place to meet and call their own.

## Suggested Downtown Building Uses

- Entertainment**
  - Restaurant
  - Brewery
  - Small theater
  - Art gallery
- Residential**
  - Apartments
  - Townhouses
  - Condominiums
- Service**
  - Grocery
  - Gas
  - Bank
  - Post office
  - Office
  - Barber shop
- Retail**
  - Convenience
  - Antique
  - Clothing
  - Electronic
  - Home
  - Sporting good

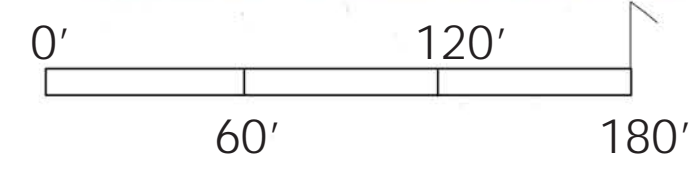
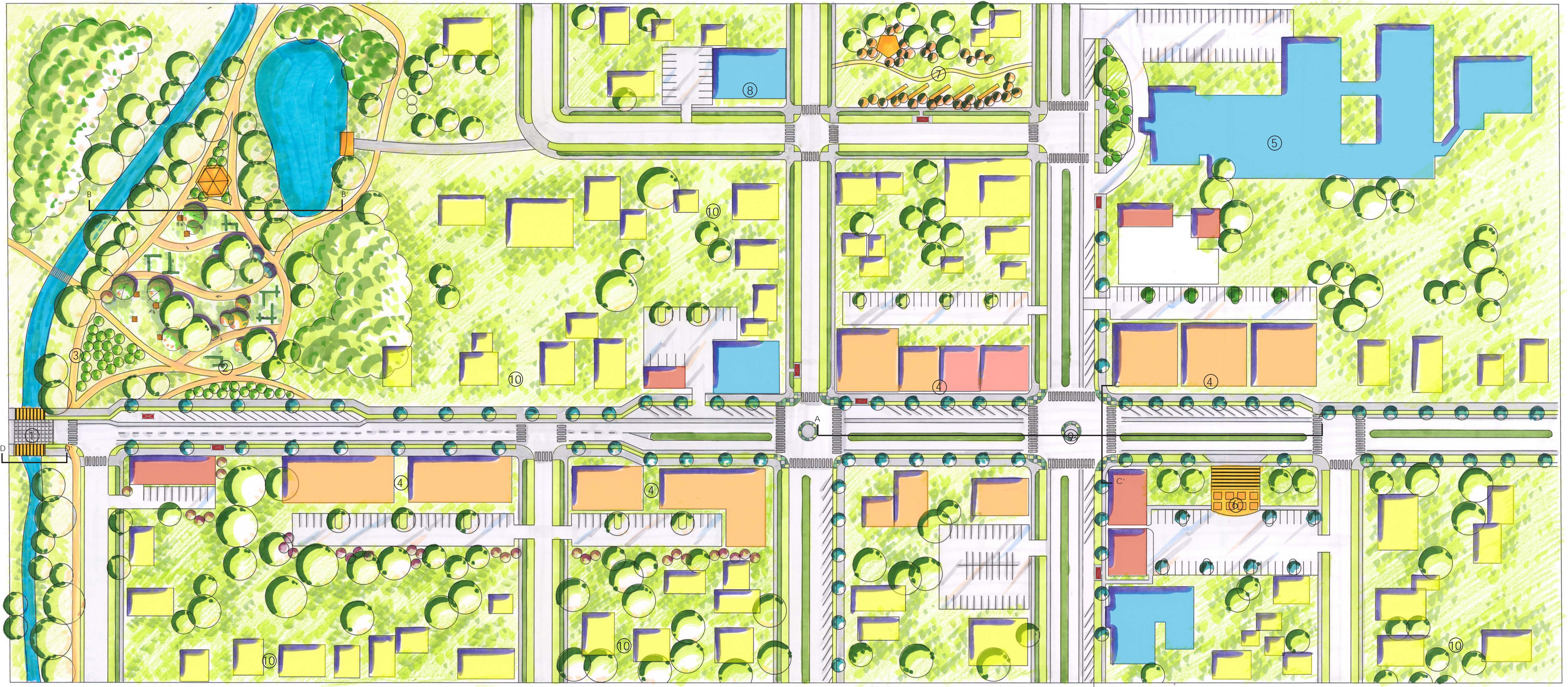

### Site Notes

- West Bridge:** This primary entrance is a gateway into Webberville. It is framed by vertical sculptural pieces that highlight the bridge's pedestrian walkways.
- Gazebo Park:** Gazebo park is the new home to Webberville's well known Gazebo. Amenities include picnicking, natural water features and scenic bike/walking trail.
- Bike Trail:** This trail connects the industrial park on the West end of the city with the core of the downtown.
- Mixed Use Downtown:** The downtown business district has been renovated, bringing the store fronts to the edge of the street and zoning them to be mixed use.
- School:** The Historic Elementary school is now highlighted along the renovated streetscape and to the new community garden.
- Trolley/Information Station:** The previous gazebo location has been converted to a new trolley and information station. The trolley would bring people westward, to and from the town primarily on weekends.
- Community Garden:** This garden space is a place for the residents, school children, FFA members and the garden club to come together, giving back to the community in a creative way.
- Recreation Center:** The rec center, located in the restored church along Cherry and Howard Street, is a space for the residents of all ages to come and socialize with one another.
- Downtown Core:** The intersection of Main and Grand River become the heart of Webberville. They feature a piece of public art, sitting within the new traffic circle. Retail, entertainment, and new eateries surround the core.
- Existing Residential:** The streetscape throughout the residential area has been adjusted to provide proper drainage, accommodate the neighborhood parking needs and complete sidewalks. The existing homes have not been rezoned or relocated.

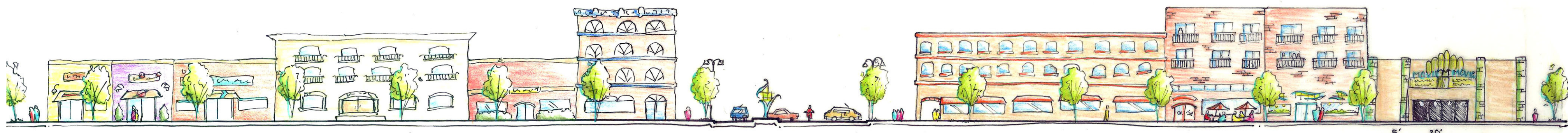

### Downtown Streetscape

Above: To attract new community members to Webberville, a variety of housing options can be found just short walk from the center of town. Apartments, lofts or town homes are located above various mixed use spaces.

### Gazebo Park

Below: Upon entering the village of Webberville visitors are greeted by an eye-catching rain garden nested at the gate of Gazebo Park. In this ideal location visitors will find the new home of the Bernie Simmons Memorial Gazebo. The gazebo will be set back from the road making it more peaceful for users. Sitting along the banks of the Kalamink creek, the park is full of spaces for picnicking, walking, riding or relaxing. The park presents a pleasant escape for village members and an exciting adventure for new visitors.



### Bridge Gateway

The bridge has become a recognizable gateway into the village. Sculptural pieces frame the road while new railings and paving define bridge.

### Downtown Street Cross Section



Above: Attractive bioswales separate the sidewalk and homes from on street parking terraces.

Left: The streetscape has been altered to create complete streets. Large sidewalks, on street parking, bioswales, narrow roads, bike lanes, and public transit have all been designed for the landscape.

## Webberville, MI Design Vision

Katie Barry  
Hongwei Tian  
Maleah Beatty  
Connections of Scale: LA 344

